

auto
SPRITZ™



Hand Sanitizer Dispenser

User Manual



Model: OAS1aw
PATENT PENDING

Installation Instructions

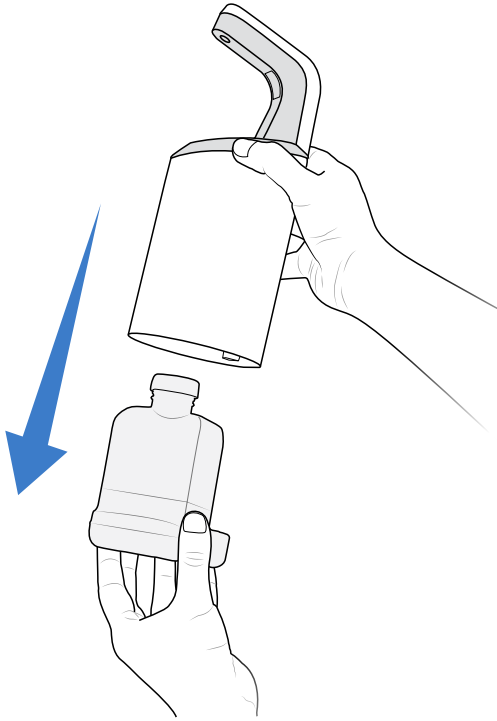

1

Remove bottle from dispenser.

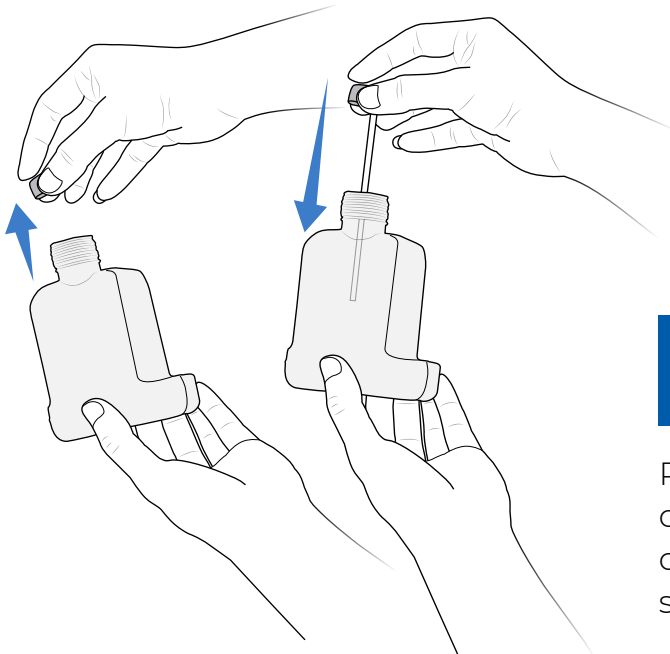

2

Remove the shipping cap (red) and insert the cap with the tube (grey), screw on tightly.

Installation Instructions cont.

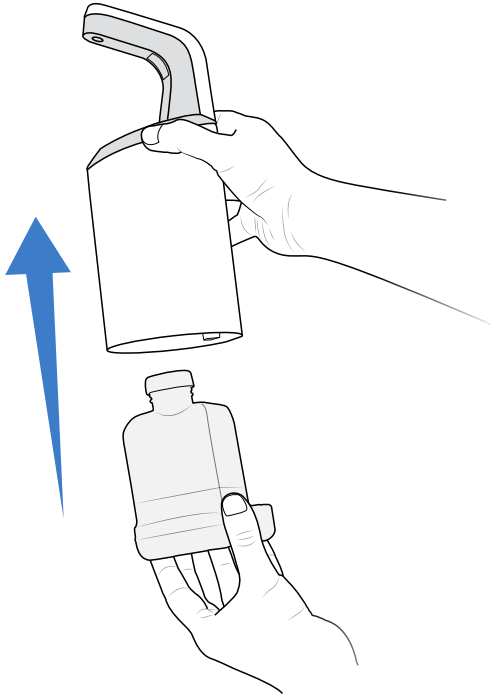

3

Put bottle back into dispenser, push firmly until it clicks.



4

Pull the plastic tab from the back of the unit to provide power to the dispenser.

Installation Instructions cont.

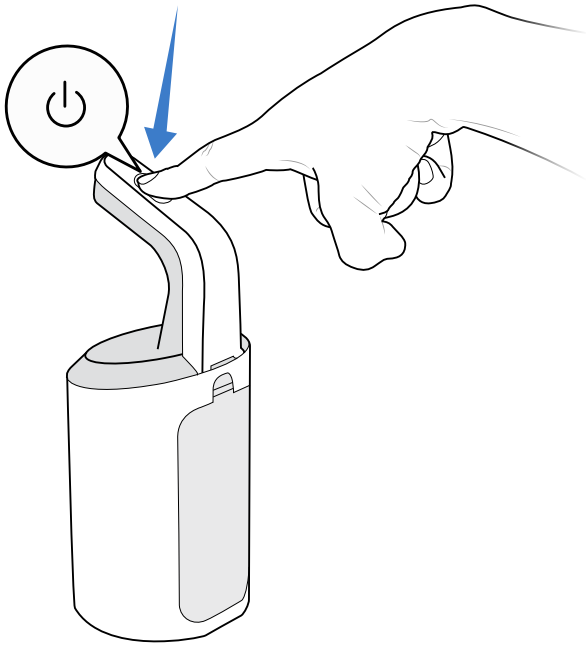

5

Touch the ON button on the top of the product until blue light lights up. Refer to LED codes for LED behaviors.

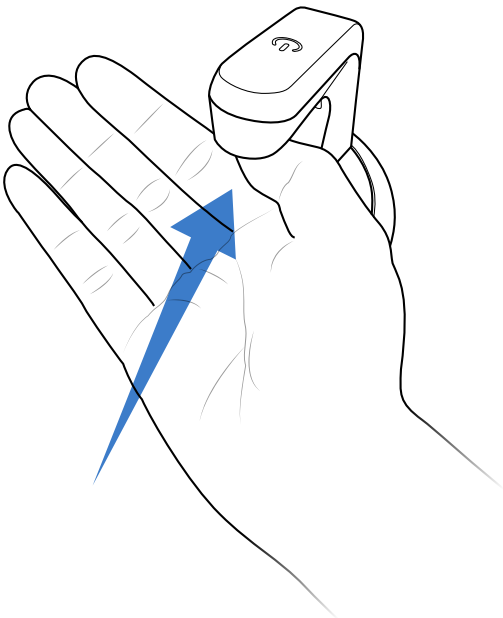

6

You are ready to auto-SPRITZ™. With one hand, or two hands together, move into the spray zone to apply sanitizer.

During first use, it is normal to activate 3-4 times before the spray comes out.

After a period of non-use, it is normal to activate several times to achieve full spray.

Installation Instructions cont.

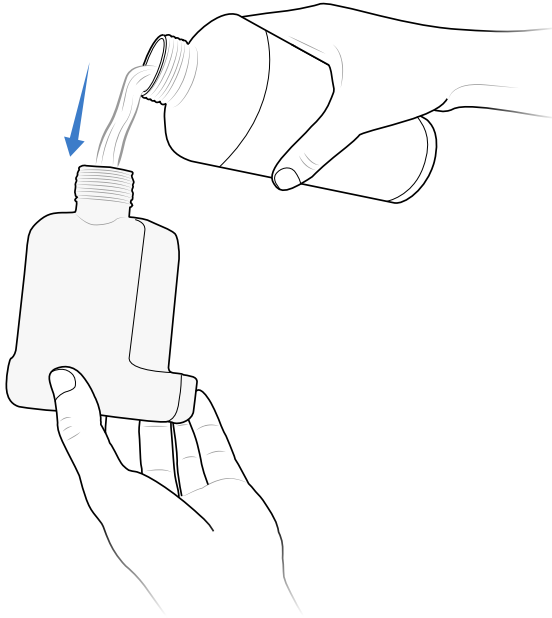

7

To refill the dispenser, purchase The Origyn Liquid Hand Sanitizer online, turn product off, remove bottle and cap, fill up bottle, replace cap, replace bottle, turn product ON.

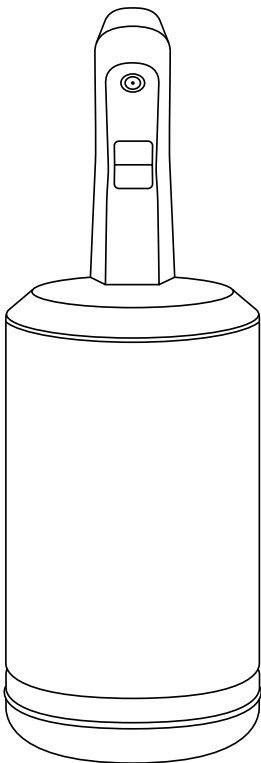

ATTENTION:

Do not leave sanitizer in direct sunlight.

Place on flat and level surface. Make sure not to allow foreign contaminants into sanitizer bottle. If you will not use the product for some time, then turn the product off. Do not carry sanitizer by goose neck.

Dispenser Status LED:

Turn-on: Touch button for one second, blue light illuminates.

Turn-off: Touch button for two seconds, red light illuminates.

Dispense: Blue light illuminated (normal operation).

Power: Red flashing 2 times during dispense. Replace AA batteries.

Technical Data:

Rated: 4 x AA batteries 6V DC

Warnings:

- Use dispenser only as directed.
- Dispensed product is for external use only. Flammable, keep away from heat or flame.
- Keep out of reach of children, if swallowed, get medical help or contact poison control.
- When using this product, keep out of eyes, ears and mouth. In case of contact with eyes, rinse eyes thoroughly with water.
- Do not use on open skin wounds.
- Discontinue use if there is skin rash or irritation.
- Discontinue use if dispenser is clogged.
- Do not expose dispenser to extreme hot (above 40°C/104°F) or extreme cold (below 5°C/41°F) or wet locations.
- Use only Origyn's Liquid Hand Sanitizer.
- Using sanitizer gel will clog dispenser.
- Insert batteries per markings inside compartment.
- Do not mix old and new batteries, or different brands.

Trouble-shooting

- Check that the batteries are inserted correctly.
- Replace the batteries.
- Check that the bottle has sanitizer.
- Check that the tube is inserted into cap.
- Check that the spray nozzle (see Fig. A) is not blocked.
- Put hands closer to IR sensor (see Fig. A).
- For more detailed trouble-shooting, refer to website: origyn.co

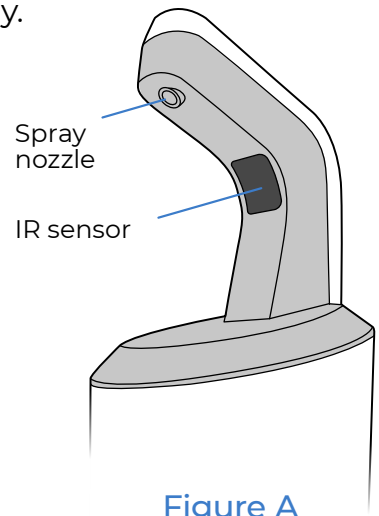

Figure A

Cleaning and Maintenance

- Clean exterior surfaces using water and mild soap.
- Do not use abrasive cleaners.
- Do not immerse .
- Dry using soft cloth.
- Examine spray nozzle (Figure A) for build-up, clean using isopropyl (rubbing) alcohol & a clean cloth.
- Wipe IR sensor with a clean dry cloth.
- Prior to installation, clean the cap and tube using isopropyl alcohol to remove any surface contaminants.

1-year limited warranty,
refer to website for more details.

Distributed by:
ORIGYN™, LLC
Boston, MA 02115
www.origyn.co
Made in China.

For refills visit:
origyn.co/product/refill

